



NIPPON KAIJI KYOKAI

Certificate

OF

APPROVAL

Certificate No.
TA21865E(R)

Item : A-60 class bulkhead
Product name : Class A60 Bulkhead
SeaRox FB 6040 / SeaRox FB 6050
Specification : See the drawings in Annex.
Applicant : Rockwool International A/S
Hovedgaden 584, DK-2640 Hedehusene, Denmark
Manufacturers : See Annex.
Testing standard : 2010 FTP Code Annex 1 / Part 3
Test report : See Annex.

THIS IS TO CERTIFY that the above type of products has been approved by Nippon Kaiji Kyokai with type approval No. 16FPA9DA, and that the products of the above type will be accepted for use onboard ships classed with the Society as complying with the relevant requirements of the Society's *Rules for the Survey and Construction of Steel Ships* and those of the *International Convention for the Safety of Life at Sea, 1974, as amended*, subject to conditional upon the manufacturers having a quality control system audited by a competent authority to ensure continuous compliance with the type approval conditions.

This certificate is valid until 14 February 2026.

Issued at Tokyo on 3 August 2021.

NIPPON KAIJI KYOKAI



Y. Takao
General Manager
Material and Equipment Department

NOTE: The design, construction and way of installation subject to attachments. Any significant changes to the product without our approval will result in this certificate becoming null and void.

Annex to the Certificate No. TA21865E(R)



1. Manufacturers

Rockwool A/S

Hovedgaden 501, 2640 Hedehusene, Denmark

Roxul Rockwool Insulation India Pvt. Ltd.

Plot Z/4, Dahej SEZ, Dahej, District Bharuch 392 130, Gujarat, India

2. Test report

Test laboratory : DBI – Danish Institute of Fire and Security Technology
Jernholmen 12, 2650 Hvidovre, Copenhagen, Denmark

Report number : PGA10661

Date of issue : 4 June 2015

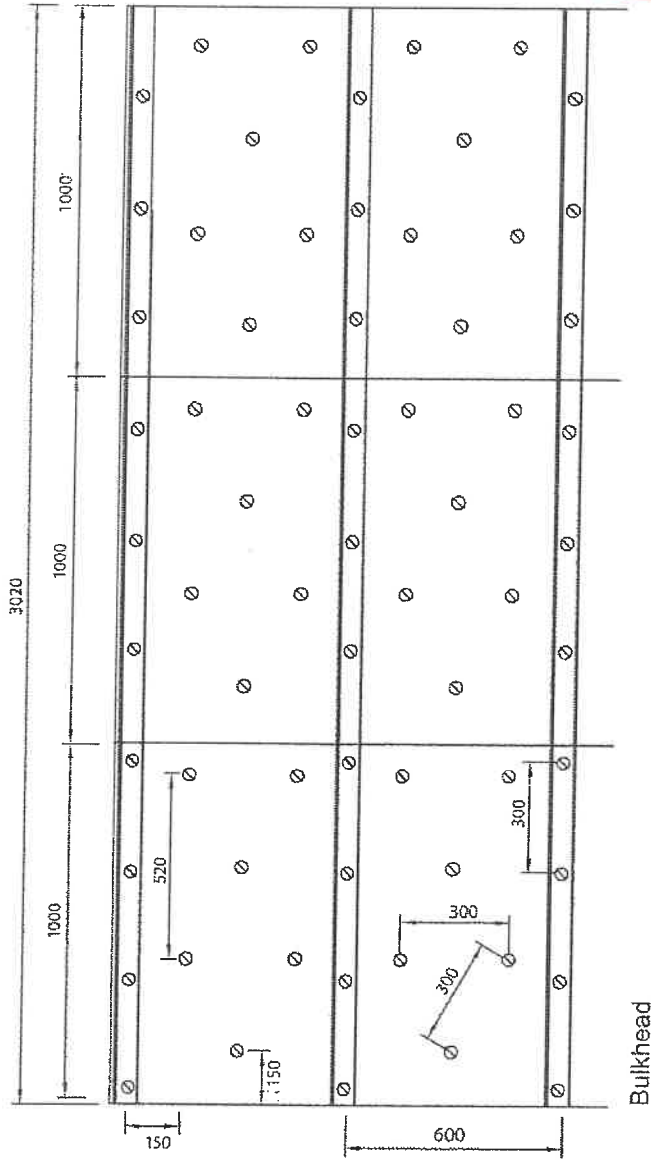

All measurements in mm

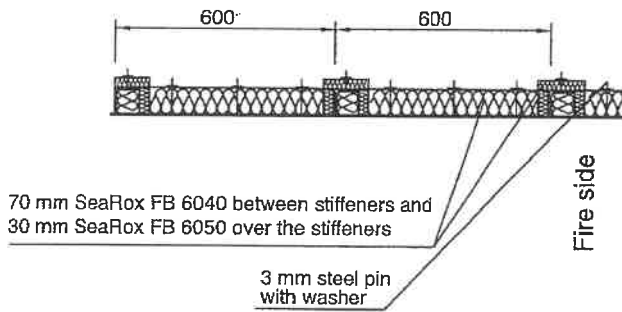

ROCKWOOL®
TECHNICAL INSULATION

Subject: A-60 Bulkhead SeaRox FB 6040/ SeaRox FB 6050

Date: 2015/07/02
Drawing No. 100-1

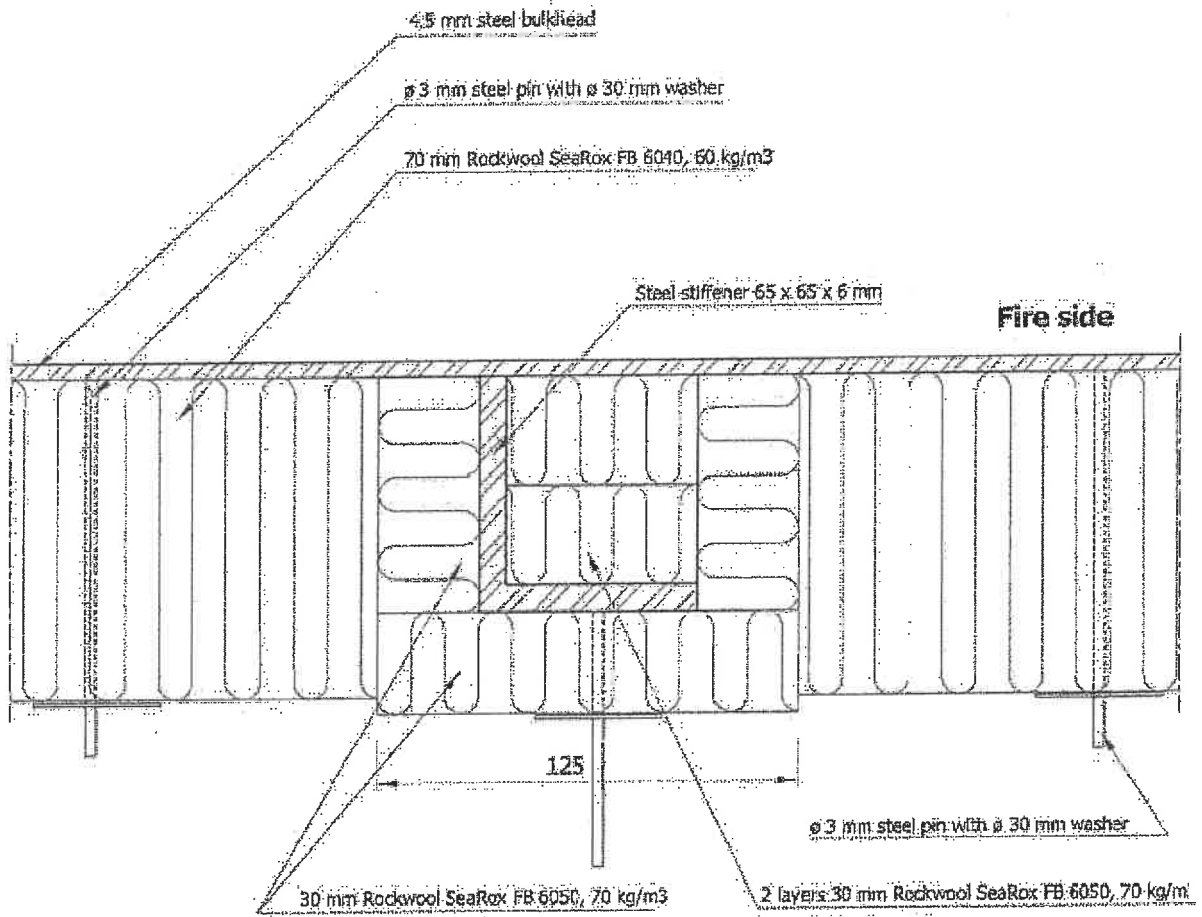

All measurements are in mm