

40mm SeaRox SL620 between stiffeners and
25mm SeaRox/S1620 over the stiffeners

3mm steel pin with 30mm washer

A-A

subject: A60 Deck SeaRox SL 620 25/40mm

ROCKWOOL®

dwg no.: 2017003

date: 2017.01.09

designer: DG **TECHNICAL INSULATION**

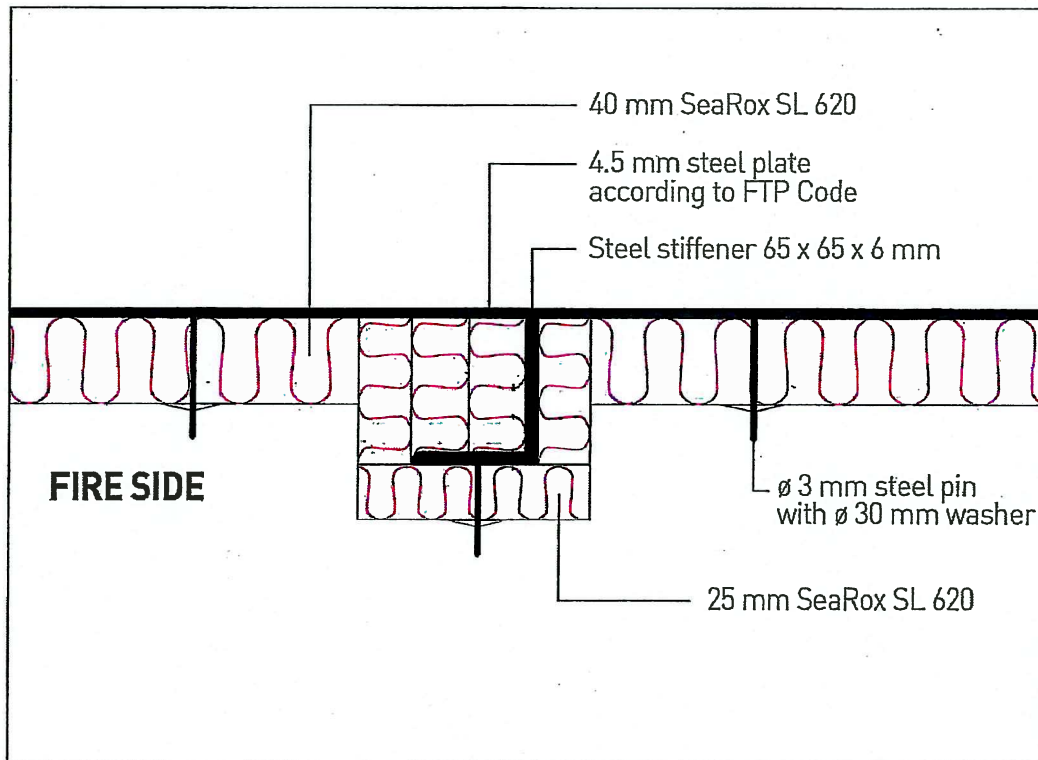

Date: 2017/09/05

Subject: A-60, SeaRox SL 620/ SeaRox SL 620

ROCKWOOL®

TECHNICAL INSULATION

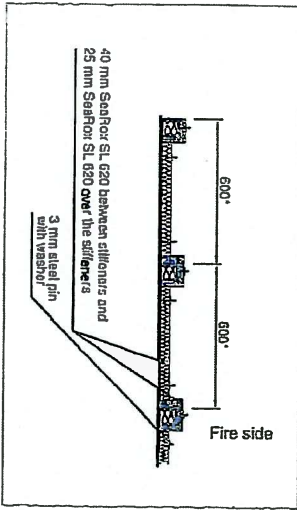

Geank's Institute of Fire and Security Technology
File no. PHA10908 B

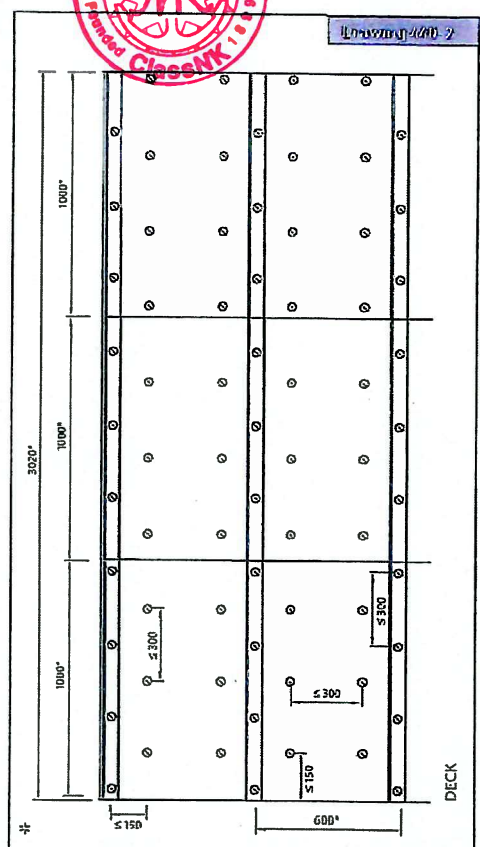
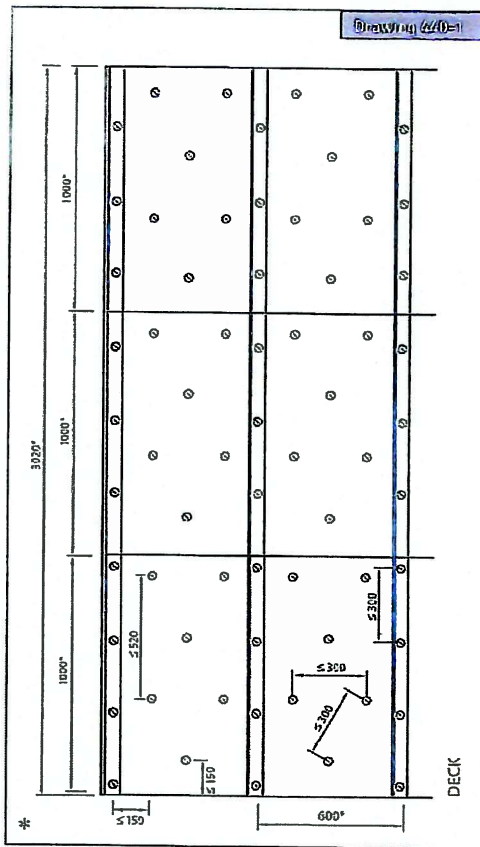

* Dimensions may vary depending on structural design and size of insulation slab.

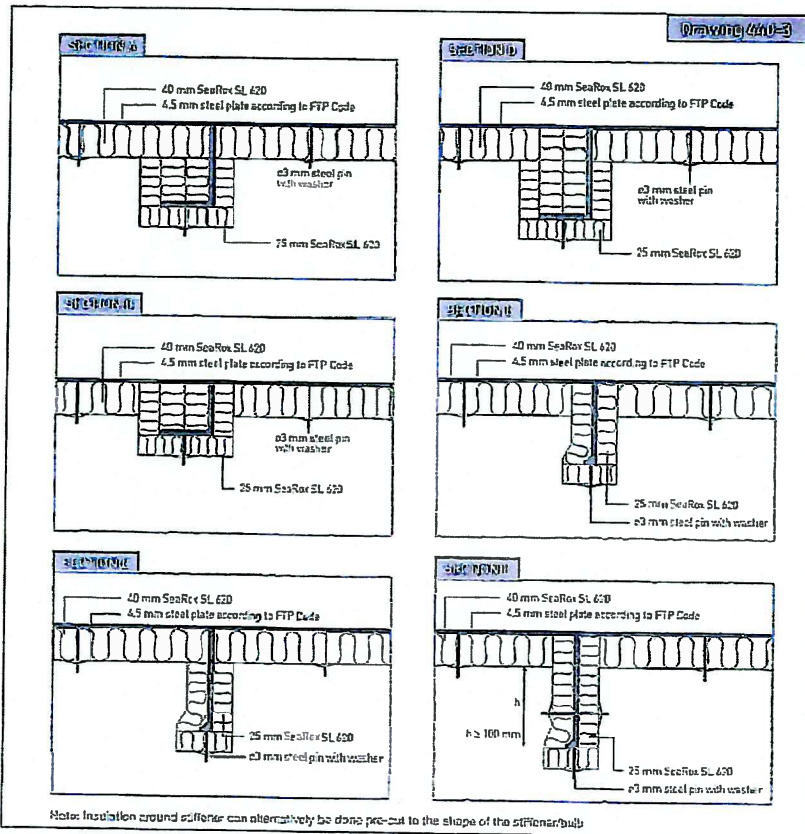

Note: Insulation around sill can alternatively be done pre-cut to the slope of the sill/flange/bulk

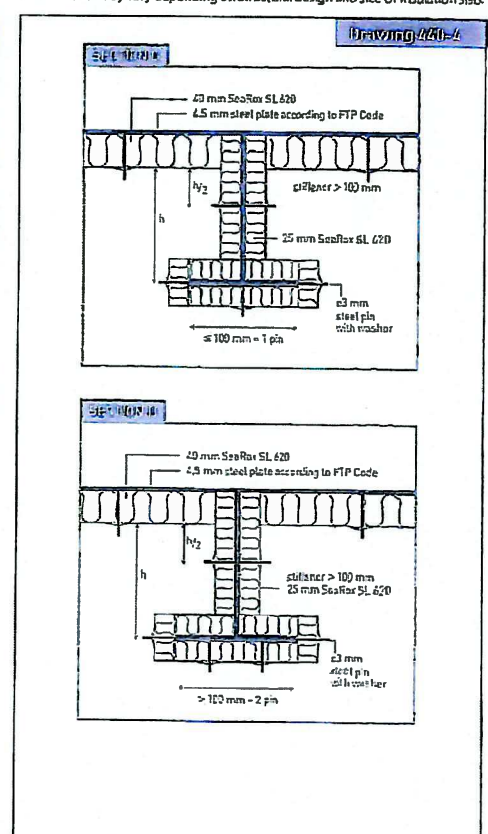

All measurements in mm

Date: 2017/02/09

Subject: A-60 Deck SeaRox SL 620/ SeaRox SL 620

Assessment Report Nos.:

ROCKWOOL®
TECHNICAL INSULATION