



CERTIFICATE NUMBER
EFFECTIVE DATE
EXPIRY DATE
ABS TECHNICAL OFFICE

20-2004330-PDA
09-Sep-2020
08-Sep-2025
London Engineering Department

CERTIFICATE OF Product Design Assessment

This is to certify that a representative of this Bureau did, at the request of

ROCKWOOL INTERNATIONAL A/S

located at

HOVEDGADEN 584, DK-2640 HEDEHUSENE, Denmark

assess design plans and data for the below listed product. This assessment is a representation by the Bureau as to the degree of compliance the design exhibits with applicable sections of the Rules. This assessment does not waive unit certification or classification procedures required by ABS Rules for products to be installed in ABS classed vessels or facilities. This certificate, by itself, does not reflect that the product is Type Approved. The scope and limitations of this assessment are detailed on the pages attached to this certificate.

Product Bulkhead, A-60 Class

Model STEEL BULKHEAD A-60 WITH SEAROX FB 6040/SEAROX FB 6050

This Product Design Assessment (PDA) Certificate remains valid until 08/Sep/2025 or until the Rules and/or Standards used in the assessment are revised or until there is a design modification warranting design reassessment (whichever occurs first).

Acceptance of product is limited to the "Intended Service" details prescribed in the certificate and as per applicable Rules and Standards.

This Certificate is valid for installation of the listed product on ABS units which exist or are under contract for construction on or previous to the effective date of the ABS Rules and standards applied at the time of PDA issuance. Use of the Product for non-ABS units is subject to agreement between the manufacturer and intended client.

American Bureau Of Shipping

Nitin Tyagi, Engineer/Consultant

NOTE: This certificate evidences compliance with one or more of the Rules, Guides, standards or other criteria of ABS or a statutory, industrial or manufacturer's standards. It is issued solely for the use of ABS, its committees, its clients or other authorized entities. Any significant changes to the aforementioned product without approval from ABS will result in this certificate becoming null and void. This certificate is governed by ABS Rules 1-1-A3/5.9 Terms and Conditions of the Request for Product Type Approval and Agreement (2010)

ROCKWOOL INTERNATIONAL A/S

HOVEDGADEN 584

DK-2640 HEDEHUSENE

Denmark

Telephone: +31 475 353915

Fax:

Email: math.mourmans@rockwool.com

Web: www.rockwool-rti.com

Tier: 3 - Type Approved, unit certification not required

Product: Bulkhead, A-60 Class

Model: STEEL BULKHEAD A-60 WITH SEAROX FB 6040/SEAROX FB 6050

Intended Service:

ABS Classed Vessels, Mobile Offshore Drilling Units or facilities.

Description:

A bulkhead (structural steel core) insulated one layer of minimum 70mm SeaRox FB 6040 - 60-100 kg/m³ on the level and with one layer of minimum 30mm SeaRox FB 6050, 70-100 kg/m³ on the stiffeners with Nominal organic content:1.1 mass % for both.

Rating:

Bulkhead, A-60 Steel Bulkhead

Service Restriction:

1) Unit Certification is not required for this product. If the manufacturer or purchaser's request an ABS Certificate for compliance with a specification or standard, the specification or standard, including inspection standards and tolerances must be clearly defined.

2) Continuous compliance with the statutory requirements requires maintenance of the Full Type Approval. The scope of Type Approval is to comply with MSC.1/Cir. 1221 dated 1 December 2006.

Comments:

1) The Manufacturer has provided a declaration about the control of, or lack of Asbestos in this product.

2) Unless specifically directed by the Administration, this approval is not to be construed as a substitute of a flag Administration's approval for the purpose of SOLAS 1974, as amended.

3) In those instances where flag administration may have their own specific requirements, flag Administration's approval may be required.

Notes/Drawing/Documentation:

Incoming email from Lukas Vonsik,

PDA Application form,

PDA-DUP Application,

No Changes - Declaration of Conformity,

Drawing No. PGA10661, Test Report. Class A-60 Bulkhead

Drawing No. PHA10631a, Assessment Report, Dated 7 July 2015

Drawing No. PHA10631b, Assessment Report, Dated 7 July 2015

Drawing No. PHA10631c, Assessment Report, Dated 7 July 2015

Drawing No. PHA10631d, Assessment Report, Dated 7 July 2015

Drawing No. PHA10631e, Assessment Report, Dated 7 July 2015

Terms of Validity:

This Product Design Assessment (PDA) Certificate remains valid until 08/Sep/2025 or until the Rules and/or Standards used in the assessment are revised or until there is a design modification warranting design reassessment (whichever occurs first).

Acceptance of product is limited to the "Intended Service" details prescribed in the certificate and as per applicable Rules and Standards.

This Certificate is valid for installation of the listed product on ABS units which exist or are under contract for construction on or previous to the effective date of the ABS Rules and standards applied at the time of PDA issuance.

ROCKWOOL INTERNATIONAL A/S

HOVEDGADEN 584

DK-2640 HEDEHUSENE

Denmark

Telephone: +31 475 353915

Fax:

Email: math.mourmans@rockwool.com

Web: www.rockwool-rti.com

Tier: 3 - Type Approved, unit certification not required

Use of the Product for non-ABS units is subject to agreement between the manufacturer and intended client.

STANDARDS

ABS Rules:

ABS Rules for Conditions of Classification 2020: 1-1-4/7.7, 1-1-A3, 1-1-A4

ABS Rules for Conditions of Classification – Offshore Units and Structures, 2020: 1-1-4/9.7, 1-1-A2, 1-1-A3

National:

NA

International:

IMO Resolution A754(18)(Adopted on 4 November 1993), IMO 2010 FTP Code (2012 Edition), International Code for Application of Fire Test Procedures, 2010, 2012 Edition

Government:

NA

EUMED:

NA

OTHERS:

NA



CERTIFICATE NUMBER
EFFECTIVE DATE
EXPIRY DATE
ABS TECHNICAL OFFICE

20-2004330-PDA-DUP
09-Sep-2020
08-Sep-2025
London Engineering Department

CERTIFICATE OF Product Design Assessment

This is to certify that a representative of this Bureau did, at the request of

ROXUL ROCKWOOL INSULATION INDIA PVT. LTD.

located at

**PLOT Z/4 DAHEJ SEZ, DAHEJ, DISTRICT BHARUCH, GUJARAT,
India, 392130**

assess design plans and data for the below listed product. This assessment is a representation by the Bureau as to the degree of compliance the design exhibits with applicable sections of the Rules. This assessment does not waive unit certification or classification procedures required by ABS Rules for products to be installed in ABS classed vessels or facilities. This certificate, by itself, does not reflect that the product is Type Approved. The scope and limitations of this assessment are detailed on the pages attached to this certificate.

Product Bulkhead, A-60 Class

Model STEEL BULKHEAD A-60 WITH SEAROX FB 6040/SEAROX FB 6050

This Product Design Assessment (PDA) Certificate remains valid until 08/Sep/2025 or until the Rules and/or Standards used in the assessment are revised or until there is a design modification warranting design reassessment (whichever occurs first).

Acceptance of product is limited to the "Intended Service" details prescribed in the certificate and as per applicable Rules and Standards.

This Certificate is valid for installation of the listed product on ABS units which exist or are under contract for construction on or previous to the effective date of the ABS Rules and standards applied at the time of PDA issuance. Use of the Product for non-ABS units is subject to agreement between the manufacturer and intended client.

American Bureau Of Shipping

Nitin Tyagi, Engineer/Consultant

NOTE: This certificate evidences compliance with one or more of the Rules, Guides, standards or other criteria of ABS or a statutory, industrial or manufacturer's standards. It is issued solely for the use of ABS, its committees, its clients or other authorized entities. Any significant changes to the aforementioned product without approval from ABS will result in this certificate becoming null and void. This certificate is governed by ABS Rules 1-1-A3/5.9 Terms and Conditions of the Request for Product Type Approval and Agreement (2010)

ROXUL ROCKWOOL INSULATION INDIA PVT. LTD.

PLOT Z/4 DAHEJ SEZ

DAHEJ, DISTRICT BHARUCH GUJARAT

India 392130

Telephone: +91 610835284

Fax:

Email: prashant.tumdi@rockwool.com

Web: www.rockwool-searox.com

Tier: 3 - Type Approved, unit certification not required

Product: Bulkhead, A-60 Class

Model: STEEL BULKHEAD A-60 WITH SEAROX FB 6040/SEAROX FB 6050

Intended Service:

ABS Classed Vessels, Mobile Offshore Drilling Units or facilities.

Description:

A bulkhead (structural steel core) insulated one layer of minimum 70mm SeaRox FB 6040 - 60-100 kg/m³ on the level and with one layer of minimum 30mm SeaRox FB 6050, 70-100 kg/m³ on the stiffeners with Nominal organic content:1.1 mass % for both.

Rating:

Bulkhead, A-60 Steel Bulkhead

Service Restriction:

1) Unit Certification is not required for this product. If the manufacturer or purchaser's request an ABS Certificate for compliance with a specification or standard, the specification or standard, including inspection standards and tolerances must be clearly defined.

2) Continuous compliance with the statutory requirements requires maintenance of the Full Type Approval. The scope of Type Approval is to comply with MSC.1/Cir. 1221 dated 1 December 2006.

Comments:

1) The Manufacturer has provided a declaration about the control of, or lack of Asbestos in this product.

2) Unless specifically directed by the Administration, this approval is not to be construed as a substitute of a flag Administration's approval for the purpose of SOLAS 1974, as amended.

3) In those instances where flag administration may have their own specific requirements, flag Administration's approval may be required.

Notes/Drawing/Documentation:

Incoming email from Lukas Vonsik,

PDA Application form,

PDA-DUP Application,

No Changes - Declaration of Conformity,

Drawing No. PGA10661, Test Report. Class A-60 Bulkhead

Drawing No. PHA10631a, Assessment Report, Dated 7 July 2015

Drawing No. PHA10631b, Assessment Report, Dated 7 July 2015

Drawing No. PHA10631c, Assessment Report, Dated 7 July 2015

Drawing No. PHA10631d, Assessment Report, Dated 7 July 2015

Drawing No. PHA10631e, Assessment Report, Dated 7 July 2015

Terms of Validity:

This Product Design Assessment (PDA) Certificate remains valid until 08/Sep/2025 or until the Rules and/or Standards used in the assessment are revised or until there is a design modification warranting design reassessment (whichever occurs first).

Acceptance of product is limited to the "Intended Service" details prescribed in the certificate and as per applicable Rules and Standards.

This Certificate is valid for installation of the listed product on ABS units which exist or are under contract for construction on or previous to the effective date of the ABS Rules and standards applied at the time of PDA issuance.

ROXUL ROCKWOOL INSULATION INDIA PVT. LTD.

PLOT Z/4 DAHEJ SEZ

DAHEJ, DISTRICT BHARUCH GUJARAT

India 392130

Telephone: +91 610835284

Fax:

Email: prashant.tumdi@rockwool.com

Web: www.rockwool-searox.com

Tier: 3 - Type Approved, unit certification not required

Use of the Product for non-ABS units is subject to agreement between the manufacturer and intended client.

STANDARDS

ABS Rules:

ABS Rules for Conditions of Classification 2020: 1-1-4/7.7, 1-1-A3, 1-1-A4

ABS Rules for Conditions of Classification – Offshore Units and Structures, 2020: 1-1-4/9.7, 1-1-A2, 1-1-A3

National:

NA

International:

IMO Resolution A754(18)(Adopted on 4 November 1993), IMO 2010 FTP Code (2012 Edition), International Code for Application of Fire Test Procedures, 2010, 2012 Edition

Government:

NA

EUMED:

NA

OTHERS:

NA

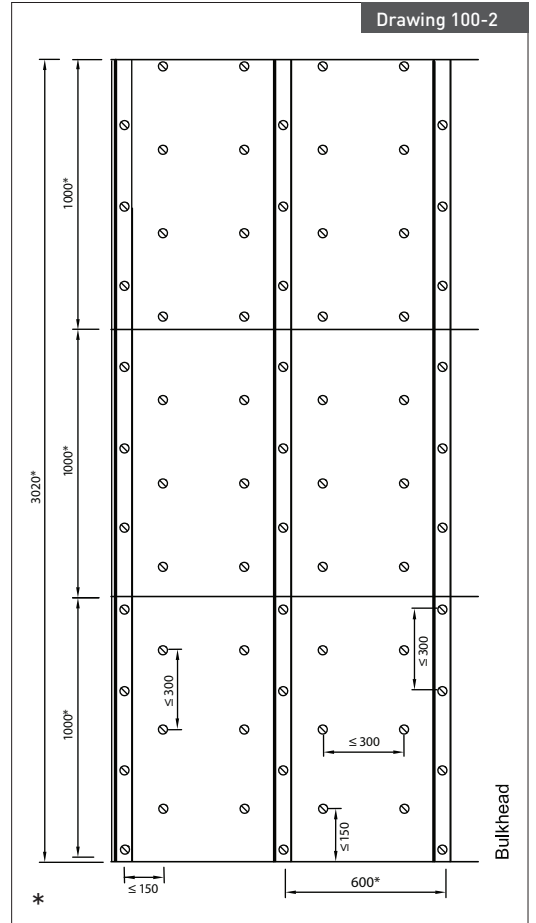
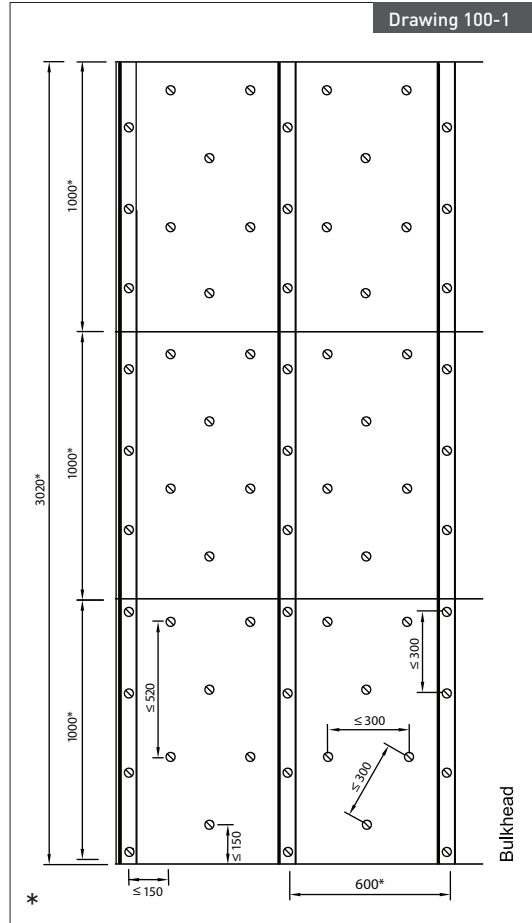
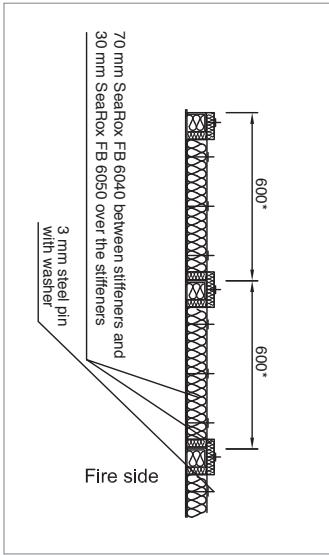

* Dimensions may vary depending on structural design and size of insulation slab.

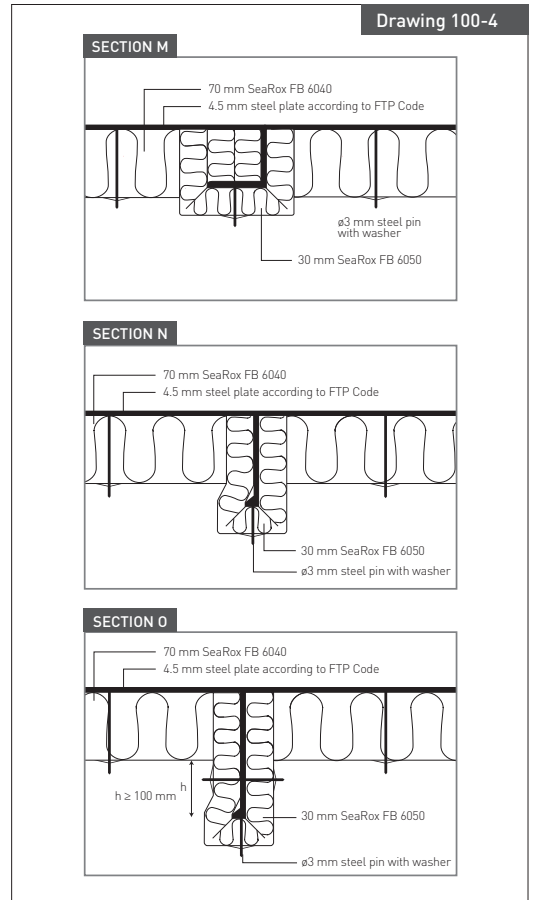
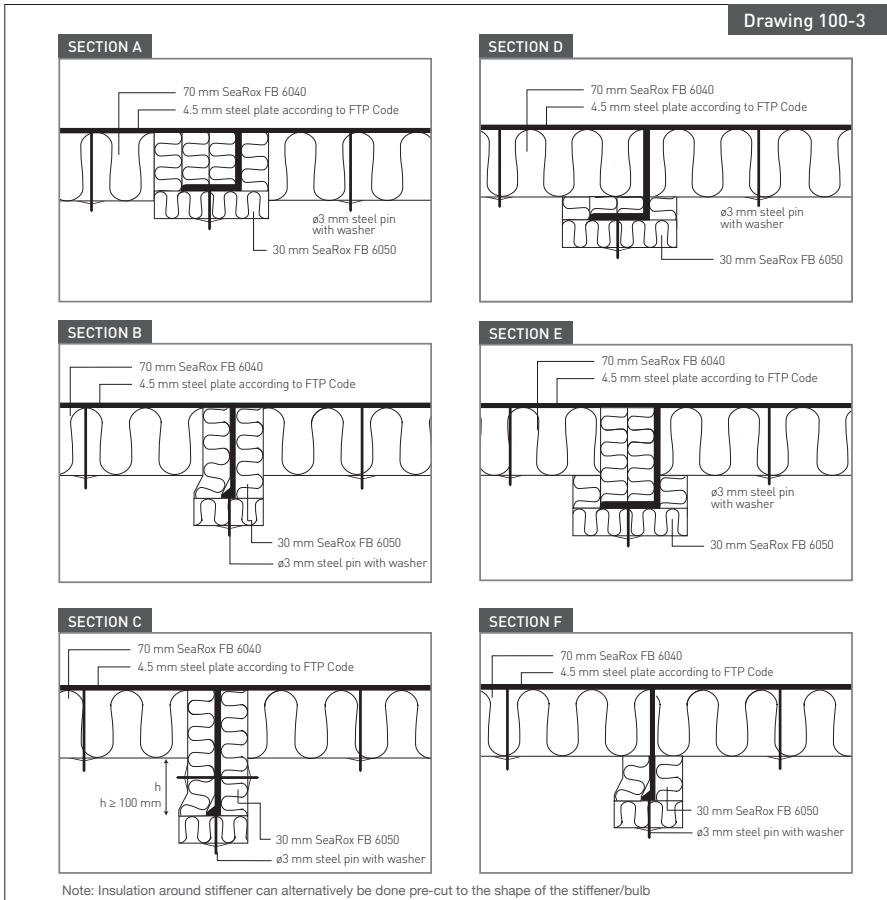

All measurements in mm

Date: 2016/12/13

Subject: A-60 Bulkhead SeaRox FB 6040/ SeaRox FB 6050

Assessment Report Nos.: PHA10631a PHA10631b PHA10631c PHA10631d PHA10631e

ROCKWOOL®

TECHNICAL INSULATION